

Clamp Board #8
Stainless steel
Size : 90 x 90mm
Board with 8 clamps : #9 x 2, 2A, W2A, 5, 56, 203 & 204
or
Board only (without clamps)
Made in Japan



Clamp Board #12
Stainless steel
Size : 150 x 90mm
Board with 12 clamps : #210, 9, 0, 2, 2A, 206, 207, 5, 56, 7, 201 & 202
or
Board only (without clamps)
Made in Japan



Clamp Board #18
Stainless steel
Size : 160 x 120mm
Board with 18 clamps : #210, 9, P-1, P-2, 22, 27, 29, 208, 209, 18, 138, 139, 7, 201, 202, 203, 204 & 205
or
Board only (without clamps)
Made in Japan



Deciduous Clamp Board
Stainless steel
Size : 90 x 90mm
#54-upper right D #64-upper left D
#65-upper right E #65-upper left E
#85-lower right E #75-lower left E
#84-lower right D #74-lower left D
or
Board only (without clamps)
Made in Japan

DENTECH Corporation
TEL:+81-3-3964-2011 FAX:+81-3-3962-5624
Web:www.dentech.co.jp Email:info@dentech.co.jp
53-5, Shimizu-cho, Itabashi-ku, Tokyo, 174-0053, JAPAN



How to choose

KSK

Rubber Dam Clamps



77 types x 3 colors

Features of KSK Rubber Dam Clamps

- KSK DENTECH Rubber Dam Clamps are made of special spring tempered stainless steel .
- This material has ideal spring action for rubber dam clamps , as well as maximum corrosion resistance .
- Various forms are available, so you can choose clamps in accordance with the teeth .
- Metal fatigue test is conducted for every production to assure good spring action and long-term use .
- For stable forms, our craftsmen adjust bending clamps one by one manually.
- All beaks are sharpening , so good to fit to the teeth .
- "BLACK" and "MATT" are our new products which avoid eye fatigue of dentists by reflecting operation light .
- All clamps are made in Japan.

Rubber Dam Technic Set

- Contents :
- ①Clamp Board #12
 - ②Rubber Dam Frame Large (Adult) .
 - ③Rubber Dam Punch .
 - ④Rubber Dam Clamp Forceps .

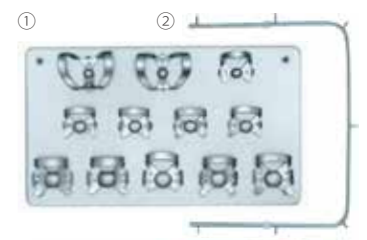

- Clamps :
- #210, #9, #0, #2, #2A, #206
#207, #5, #56, #7, #201, #202

Rubber Dam Starter Kit

- Contents :
- ①Clamp Board #12
 - ②Rubber Dam Frame Large (Adult) .
 - ③Rubber Dam Punch .
 - ④Rubber Dam Clamp Forceps .
 - ⑤Rubber Dam Template.
 - ⑥Dental Dam Non-Latex (20 sheets).

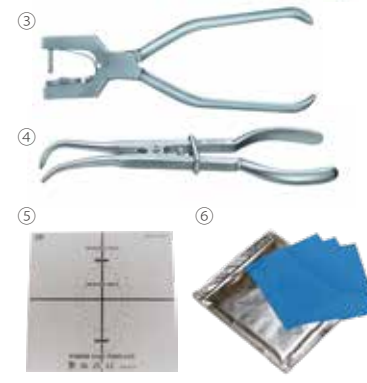

For permanent teeth

3 Colors Normal Matt Black



NEW!! 42 **NEW!!** 43
wingless



For upper left molars with flat beaks, paired with 43.
For upper right molars with flat beaks, paired with 42.

9T 2A 2AT
winged



Most popular anterior clamps.
Similar to #2, but with larger beaks. For bigger bicuspid.
Similar to #2T but with larger beaks. For bigger bicuspid.

NEW!! 44 212 29
wingless



For anteriors, canines and cavities on bicuspid labial.
Cervical clamp for labial cavities.
For upper & lower bicuspid, broad beaks for wider view.

9T 210 212 90N
winged wingless



Most popular anterior clamps.
For centrals.
Cervical clamp for labial cavities.
Strong anterior clamp.

6 9 212SA **NEW!!** 44
winged wingless



For anteriors.
Most popular anterior clamp.
Similar to #212 but little stronger to gingival.
For anteriors, canines and cavities on bicuspid labial.

208 207 206 1T 22 27 29
winged wingless



The figure is little bigger than #207. For big bicuspid.
For upper & lower bicuspid with flat beaks.
For upper & lower bicuspid with festooned beaks.
For roots deep festooned serrated beaks.
Similar to #207 but wingless.
Similar to #206, but wingless, festooned beaks.
For upper & lower bicuspid, broad beaks for wider view.

4 205 5 8A 201 14 14T 51 26 W8A U67 18
winged wingless



Similar to #3, but with festooned beaks.
For upper molars with stiff spring.
For upper molars.
For upper roots with deeply festooned beaks.
Similar to #7 but with festooned beaks.
For partially erupted molars.
For partially erupted molars.
For root furcation. Can press down the gingiva.
For upper molars especially for erupted tooth.
Similar to #8A, but wingless.
For upper second molars, compact size.
For upper & lower molars, round type beak for cervical line.

56T 14T 11 10 3 51 31 30 25 W8A 18
winged wingless



For lower, molars with festooned beaks.
For half erupted molars.
For small lower left molars. Paired with #10.
For small lower right molars. Paired with #11.
For small molars, flat beaks.
For root furcation. Can press down the gingiva.
For beaked molars. For lower furcation of subgingival. #31 and #30 are pair.
For deep buccal cavities of molars, wider fringe of buccal side. Paired with #24.
Similar to #8A, but wingless.
For upper & lower molars, round type beak for cervical line.

1 1T 1A 1AT 22 27 W2A 203 204 202 201
winged wingless winged



For roots, deep festooned beaks.
For roots deep festooned serrated beaks.
For cervical cavities of bicuspid with festooned beaks.
For subgingival cavities of bicuspid.
Similar to #207 but wingless.
Similar to #206, but wingless, festooned beaks.
Similar to #2A, but wingless.
For small lower molars right. Paired with #204.
For small lower molars left. Paired with #203.
For large molar clamp, similar to #7, but with larger beaks.
Similar to #7 but with festooned beaks.

207 208 2A 2AT
winged



For upper & lower bicuspid with flat beaks.
For big bicuspid. The fringe is little bigger than #207.
Similar to #2, but with larger beaks. For bicuspid.
Similar to #2T but with larger beaks. For bicuspid.

9T 2 2T 212 22 **NEW!!** 44
winged wingless wingless



Most popular anterior clamps.
For lower bicuspid with flat beaks.
For lower bicuspid with flat serrated beaks.
Cervical clamp for labial cavities.
Similar to #207 but wingless.
For anteriors, canines and cavities on bicuspid labial.

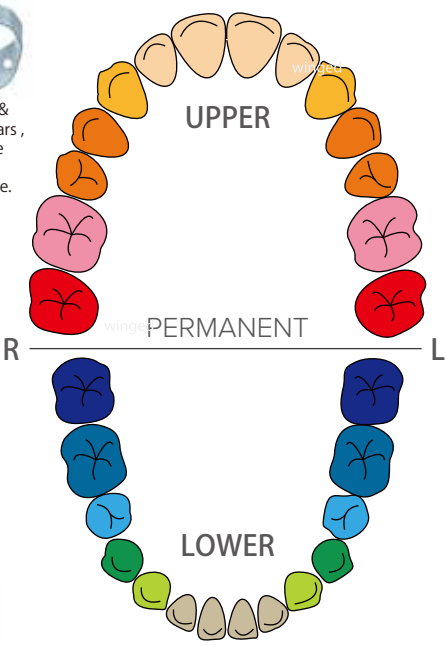

205 5 8A 201 14A 4 8 28 24 **NEW!!** 42 **NEW!!** 43
winged wingless



For upper molars with stiff spring.
For upper molars.
For upper roots with deeply festooned beaks.
Similar to #7 but with festooned beaks.
Similar to #14, but with larger beaks.
Similar to #3, but with festooned beaks.
For upper molars same size with #7. Suitable for cervical part.
For upper - lower molars. very wide fringe for wider view.
For deep buccal cavities of molars, wider fringe of buccal side. Paired with #25.
For upper left molars with flat beaks, paired with 43.
For upper right molars with flat beaks, paired with 42.

202 14 56 7 W3 31 30 28 25 15
winged wingless



For large molar clamp, similar to #7, but with larger beaks.
For half erupted molars.
Similar to #5, but with festooned beaks.
For lower molars with flat beaks.
Similar to #3, but wingless.
For beaked molars. For lower furcation of subgingival. #31 and #30 are pair.
For upper - lower molars. very wide fringe for wider view.
For deep buccal cavities of molars, with wider fringe of buccal side.
For big lower molars, with longer beak strong spring.

7A 14A 56A 14T 56T 2T 2A 2AT 1 1T 1A 1AT
winged winged winged



For very big lower molars with flat beaks.
One size larger than #14.
For large lower molars, similar to #56, but with larger beaks.
For partially erupted molars.
For lower, molars with festooned beaks.
For lower bicuspid with flat serrated beaks.
Similar to #2, but with larger beaks. For bicuspid.
Similar to #2T but larger beaks. For bicuspid.
For roots, deep festooned beaks.
For roots deep festooned serrated beaks.
For cervical cavities of bicuspid with festooned beak.
For subgingival cavities of bicuspid.

29 22 27 W2A 207 209 0 00
wingless winged



For upper & lower bicuspid, broad beaks for wider view.
Similar to #207 but wingless.
Similar to #206, but wingless, festooned beaks.
Similar to #2A, but wingless.
For upper & lower bicuspid with flat beaks.
For lower bicuspid with flat beaks.
For small bicuspid and pedo central.
Smaller than #0. Available for anteriors.

9T **NEW!!** 44 212 214
winged wingless wingless



Most popular anterior clamps.
For anteriors, canines and cavities on bicuspid labial.
Cervical clamps for labial cavities.
For exposure of the tooth neck and for temporary retraction of the gingiva. MOQ:100pcs.